

# Flow controllers, metallic DUM

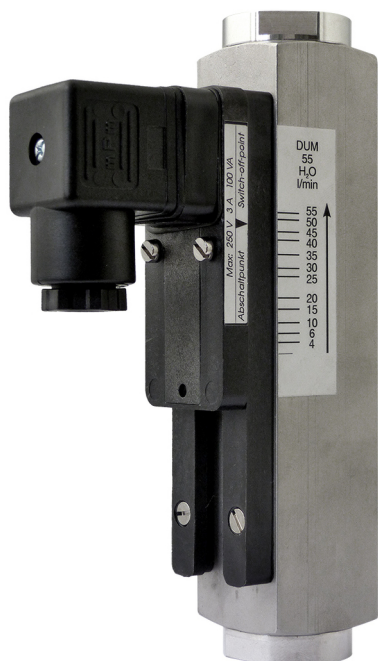

- Operates in all positions
- Blind controller, 1 contact
- Independent of pressure
- Pressure up to 300 bar
- Flow ranges from 0.2 up to 250 l/min

## APPLICATIONS

Control of flow-rate in cooling systems, high pressure washing circuit, pump safety, etc.

## DESCRIPTION

The DUM controls the flow of a liquid, free of suspended particles, having a viscosity substantially equal to water.

### Operation:

The fluid drives a magnetic orifice plate inside the cylindrical measuring tube. A spring balances its movement and allows to operate in all positions. A Reed contact, N.O. with no flow, changes of status with the passage of the magnetic orifice plate.

With these equipments, the DUM operates independently of the pressure, even with low flow-rates.

## TECHNICAL FEATURES

|                    |                                   |
|--------------------|-----------------------------------|
| Temperature limits | -20 ... 100 ° C (Option 160 ° C)  |
| Flow scales unit   | l/min (water at 20 ° C)           |
| Accuracy           | ± 5 % F.S.                        |
| Pressure drop      | 0.02 ... 0.8 bar                  |
| Flow contact       | N.O. without flow                 |
| Connector          | DIN 43650 plug-in socket<br>IP 65 |

### Brass version

|                               |                      |
|-------------------------------|----------------------|
| Pressure limit                | 200 bar              |
| Body, fittings, orifice plate | Nickel plated brass  |
| Spring                        | AISI 316 Ti (1.4571) |
| Seals                         | NBR                  |

### Stainless steel version

|                               |                      |
|-------------------------------|----------------------|
| Pressure limit                | 300 bar              |
| Body, fittings, orifice plate | AISI 316 Ti (1.4571) |
| Spring                        | AISI 316 Ti (1.4571) |
| Seals                         | FPM                  |

*Other versions: on request*

**EC Conformity** The instrument meets the legal requirements of the current European Directives.

**BAMO** INTERNATIONAL

22, Rue de la Voie des Bans · Z.I. de la gare · 95100 ARGENTEUIL

Tel +33 (0)1 30 25 83 20 Web [www.bamo.eu](http://www.bamo.eu)

Fax +33 (0)1 34 10 16 05 E-mail [export@bamo.fr](mailto:export@bamo.fr)

Flow controllers, metallic  
**DUM**

05-12-2019

D-725.01-EN-AA

**DEB**

**725-01 /1**

## SWITCH FEATURES

Adjustment: The housing slides along the body for threshold adjustment; 2 screws fix the setting safely.

### Standard supply, N.O. contact with no flow:

Rated: 230 V / 3 A / 100 VA

### OPTION : Change-over contact

Rated: 250 V / 1.5 A / 50 VA

### Contacts Ex in correspondance with ATEX directives:

ATEX II 2 G Ex mb II T6 & ATEX II 2 D Ex tD A21 IP67 T80 °C

ATEX II 2 G Ex mb II T5 & ATEX II 2 D Ex tD A21 IP67 T100 °C

N.O. Contact: 250 V / 2 A / 60 VA; Changeover contact: 250 V / 1 A / 30 VA

## CODE NUMBERS, REFERENCES, DIMENSIONS

| Code    |             | Reference | Flow range<br>[ l/min ] | Fittings BSPF<br>G | Dimensions [ mm ] |     |     |    |    | Mass<br>[ g ] |
|---------|-------------|-----------|-------------------------|--------------------|-------------------|-----|-----|----|----|---------------|
| Brass   | AISI 316 Ti |           |                         |                    | D2                | L2  | A4  | T  | SW |               |
| 725 300 | 725 500     | DUM-4     | 0.2 ... 4               | 1/4"               | 30                | 131 | 88  | 10 | 27 | 900           |
| 725 307 | 725 507     | DUM-5     | 0.6 ... 5               |                    |                   |     |     |    |    |               |
| 725 309 | 725 509     | DUM-8     | 0.5 ... 8               |                    |                   |     |     |    |    |               |
| 725 320 | 725 520     | DUM-14    | 1...14                  |                    |                   |     |     |    |    |               |
| 725 323 | 725 523     | DUM-28    | 1...28                  | 1/2"               | 30                | 131 | 88  | 14 | 27 | 900           |
| 725 326 | 725 526     | DUM-40    | 2...40                  |                    |                   | 146 |     |    |    | 950           |
| 725 329 | 725 529     | DUM-55    | 4...55                  |                    |                   |     |     |    |    |               |
| 725 331 | 725 531     | DUM-70    | 1...70                  | 1"                 | 40                | 156 | 98  | 17 | 40 | 1 100         |
| 725 333 | 725 533     | DUM-90    | 8...90                  |                    |                   |     |     |    |    |               |
| 725 335 | 725 535     | DUM-110   | 5...110                 |                    |                   |     |     |    |    |               |
| 725 337 | 725 537     | DUM-150   | 10...150                |                    |                   |     |     |    |    |               |
| 725 339 | 725 539     | DUM-220   | 35...220                | 1 1/4"             | 50                | 200 | 108 | 20 | 50 | 2 750         |
| 725 341 | 725 541     | DUM-250   | 35...250                |                    |                   |     |     |    |    | 3 000         |
|         |             |           |                         | 1 1/2"             | 60                | 200 | 116 | 20 | 60 | 3 800         |

On request, the models with fittings 1/4" G are available with thread 1/2" G (T = 14 mm)

On request, the model DUM-28 may be supply with fittings 1/4" G (T = 10 mm)

On request, the models with fittings 1" G are available with thread 3/4" G (L = 152 mm & T = 15 mm)

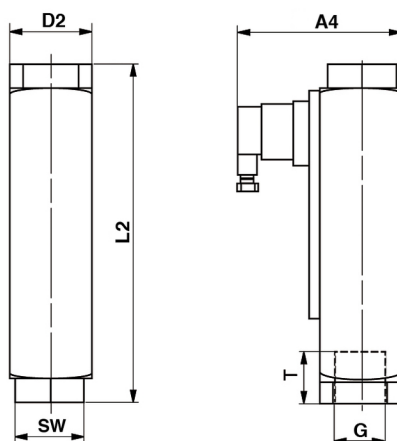

# BAMO INTERNATIONAL

22, Rue de la Voie des Bans · Z.I. de la gare · 95100 ARGENTEUIL

Tel +33 (0)1 30 25 83 20 Web [www.bamo.eu](http://www.bamo.eu)

Fax +33 (0)1 34 10 16 05 E-mail [export@bamo.fr](mailto:export@bamo.fr)

Flow controllers, metallic  
**DUM**

DEB

725-01 /2

05-12-2019

D-725.01-EN-AA